

Rehoboth Beach City Hall Complex:

Task Force CD Meeting 3 Rehoboth Beach, Delaware

September 9, 2015

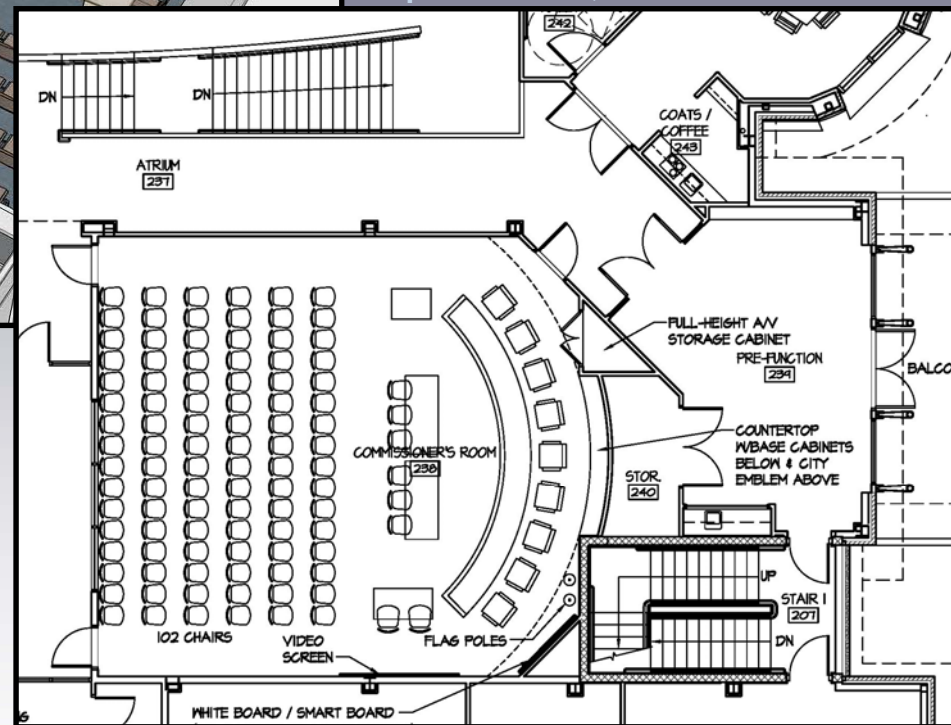

ARCHITECTS ENGINEERS SURVEYORS

ONE PLAZA EAST, SUITE 200 PO. BOX 93 SALISBURY, MD 21803-0093
TEL 410.543.9091 FAX 410.543.4172
23 NORTH WALNUT STREET PO. BOX 809 MILFORD, DE 19963
TEL 302.424.1441 FAX 302.424.0430
WEB www.dbfinc.com

Meeting Agenda

- Welcome
- Update: Project Status
- Review: Proposed AV for Commissioner's Room
- Review: Commissioner's Room 3D Options
- Review: Proposed Exterior Materials
- Review: Updated Costs and Schedule

Rehoboth Beach
City Hall Complex



ARCHITECTS ENGINEERS SURVEYORS

ONE PLAZA EAST, SUITE 200 PO. BOX 93 SALISBURY, MD 21803-0093
TEL 410.543.9091 FAX 410.543.4172
23 NORTH WALNUT STREET PO. BOX 809 MILFORD, DE 19963
TEL 302.424.1441 FAX 302.424.0430
WEB www.dbfinc.com

Review: Commissioner's Room 3D

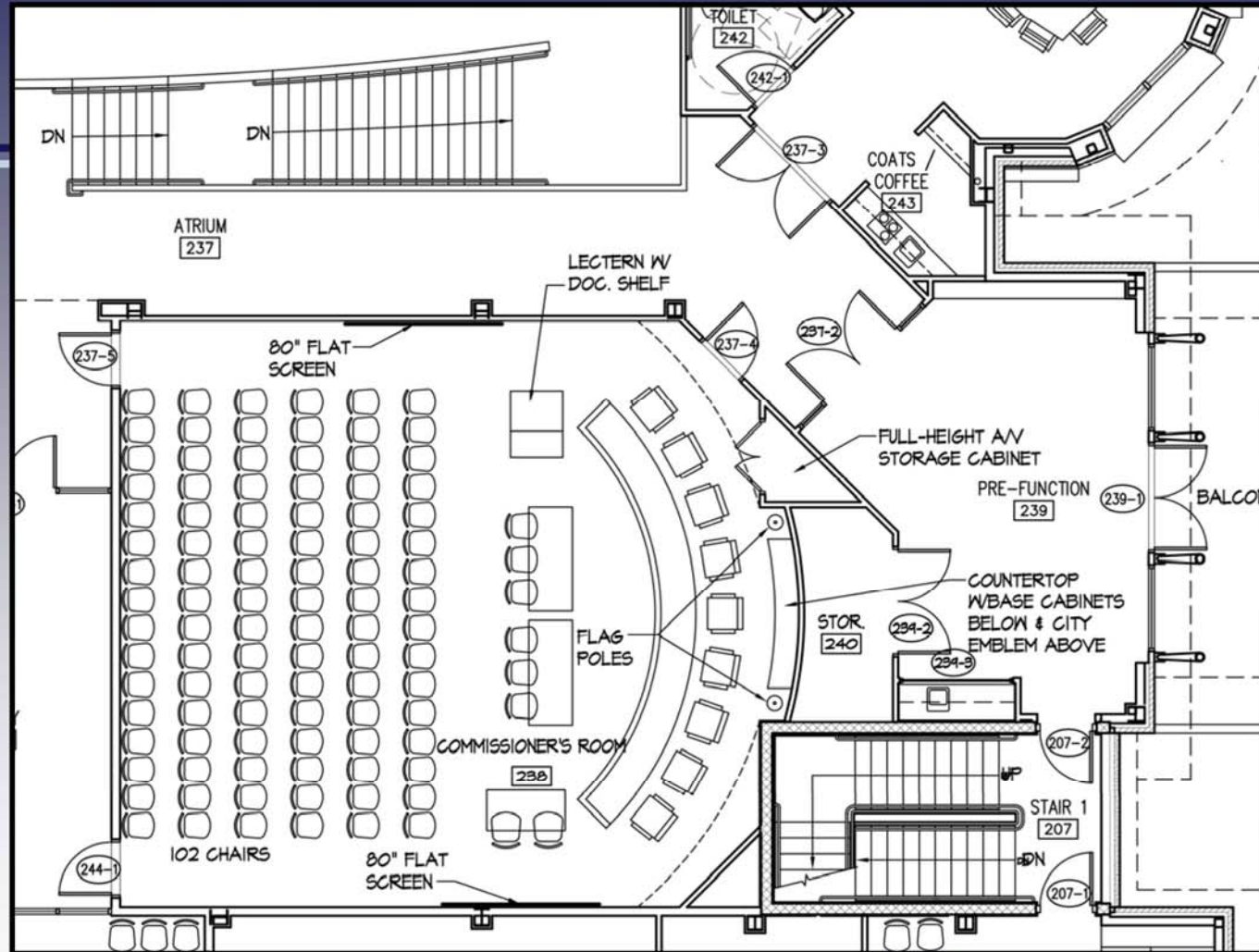

Commissioner's Room



DAVIS
BOWEN &
FRIEDEL, INC.



ARCHITECTS ENGINEERS SURVEYORS

ONE PLAZA EAST SUITE 200 PO BOX 93 SALISBURY, MD 21803-0093
TEL 410.543.6091 FAX 410.543.6172
22 NORTH WALNUT STREET PO BOX 809 MARYLAND, DE 19963
TEL 302.424.1441 FAX 302.424.0430
WEB www.davisbowl.com

Review: Commissioner's Room 3D

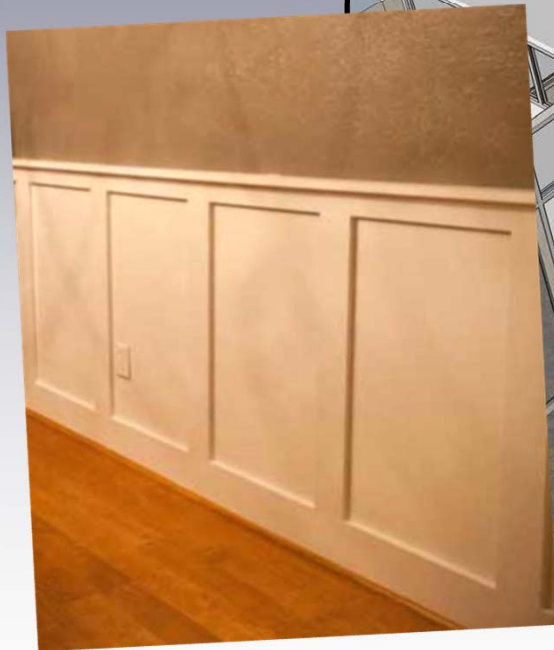
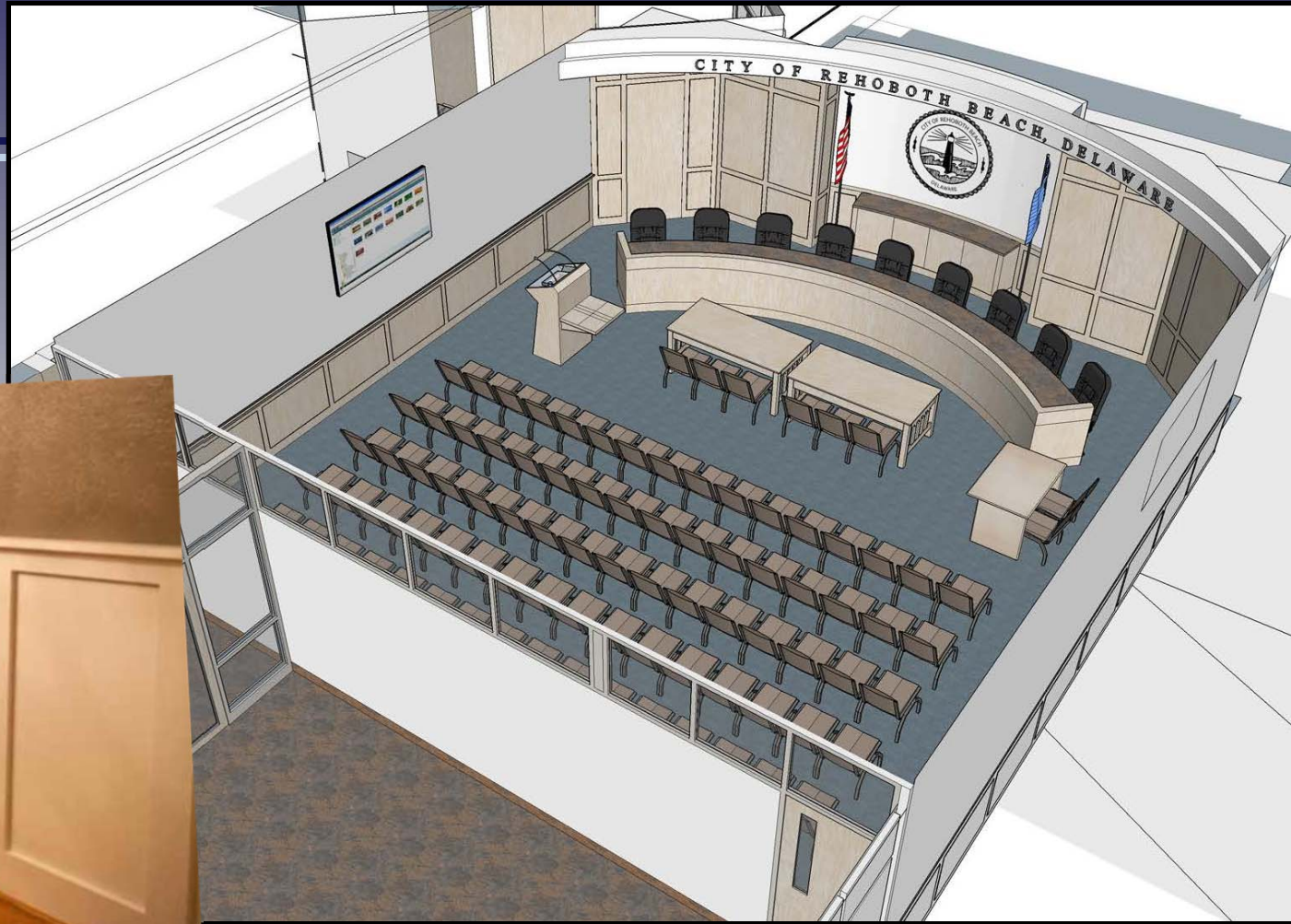

Option 1: Wood Wainscot



ARCHITECTS ENGINEERS SURVEYORS

ONE PLAZA EAST, SUITE 200 P.O. BOX 93 SALISBURY, MD 21803-0093
TEL 410.543.9091 FAX 410.543.4172
23 NORTH WALNUT STREET P.O. BOX 809 MILFORD, DE 19963
TEL 302.424.1441 FAX 302.424.0430
WEB www.dbfinc.com

Review: Commissioner's Room 3D



Option 1: Wood Wainscot



**DAVIS
BOWEN &
FRIEDEL, INC.**



ARCHITECTS ENGINEERS SURVEYORS

ONE PLAZA EAST, SUITE 200 PO. BOX 93 SALISBURY, MD 21803-0093
TEL 410.543.9091 FAX 410.543.4172
23 NORTH WALNUT STREET PO. BOX 809 MILFORD, DE 19963
TEL 302.424.1441 FAX 302.424.0430
WEB www.dbfinc.com



ONE PLAZA EAST SUITE 200 PO BOX 93 SALISBURY, MD 21803-0093
TEL 410.543.9091 FAX 410.543.4172
23 NORTH WALNUT STREET PO BOX 809 MILFORD, DE 19963
TEL 302.424.1441 FAX 302.424.0430
WEB www.dhinc.com

Review: Commissioner's Room 3D

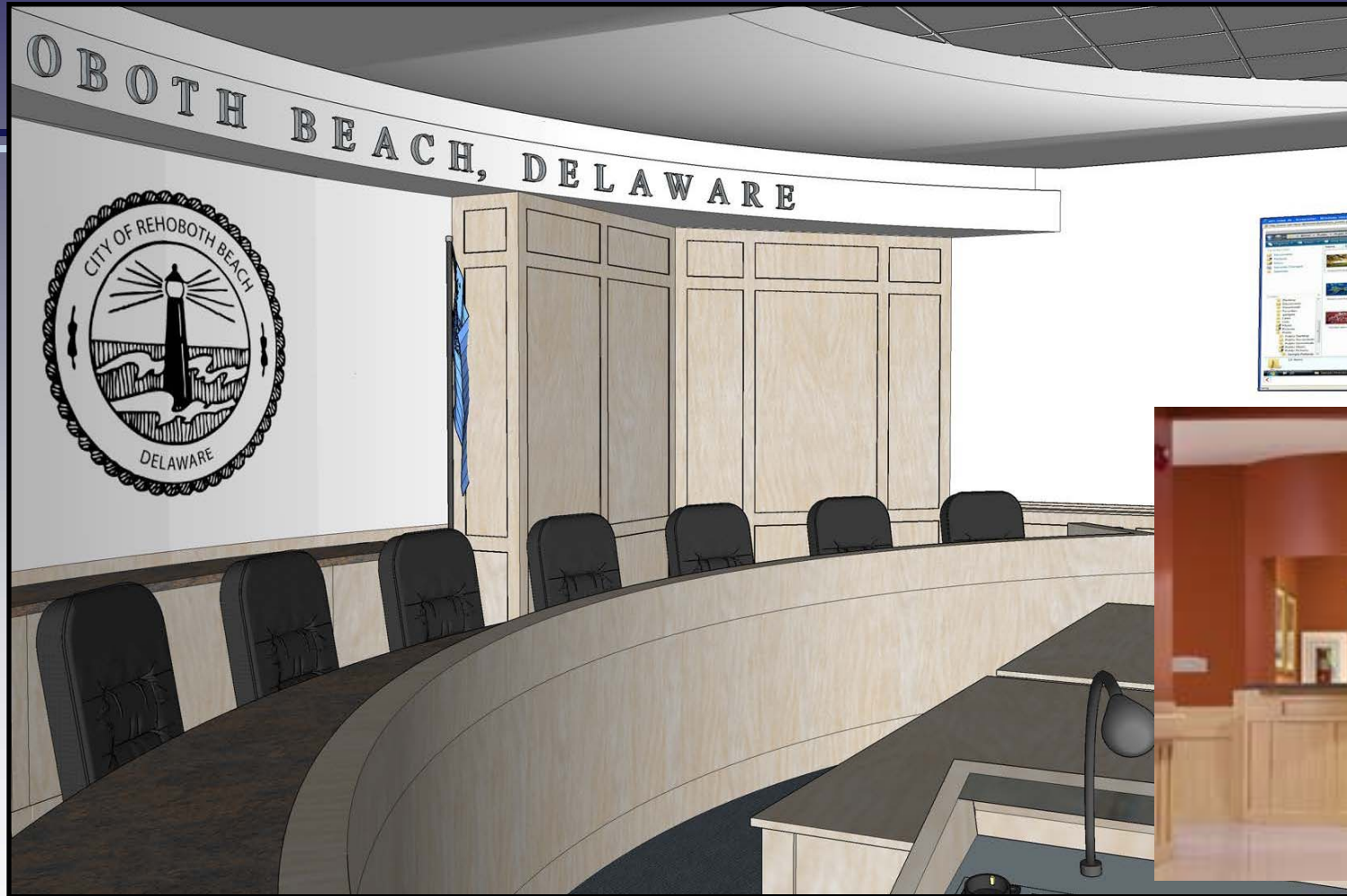

Option 1: Wood Wainscot



DAVIS
BOWEN &
FRIEDEL, INC.



ARCHITECTS ENGINEERS SURVEYORS

ONE PLAZA EAST, SUITE 200 PO. BOX 93 SALISBURY, MD. 21803-0093
TEL 410.543.9091 FAX 410.543.4172
23 NORTH WALNUT STREET PO. BOX 809 MILFORD, DE. 19963
TEL 302.424.1441 FAX 302.424.0430
WEB www.dbfinc.com

Review: Commissioner's Room 3D

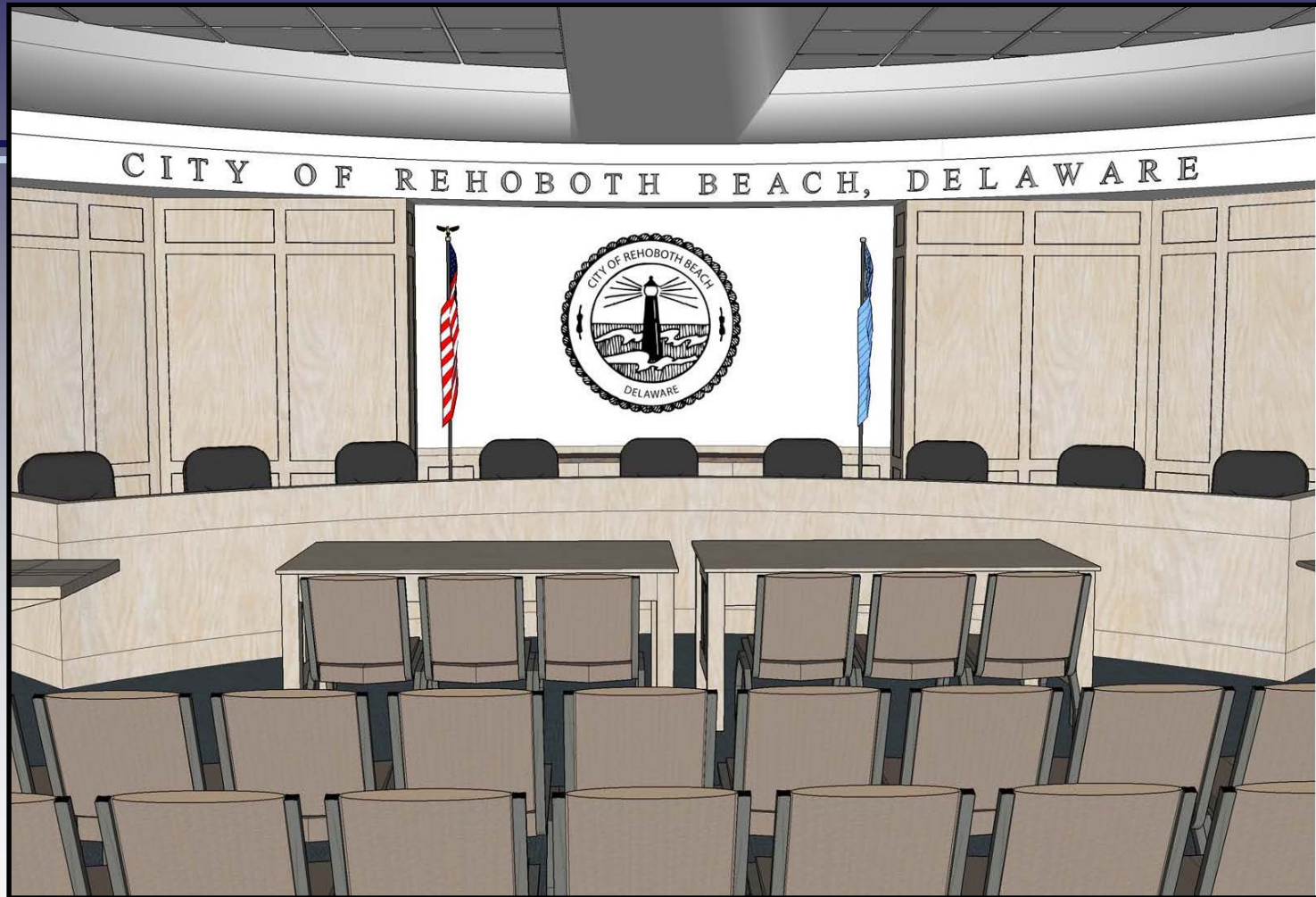

Option 1: Wood Wainscot



ARCHITECTS ENGINEERS SURVEYORS

ONE PLAZA EAST, SUITE 200 P.O. BOX 93 SALISBURY, MD 21803-0093
TEL 410.543.9091 FAX 410.543.4172
23 NORTH WALNUT STREET P.O. BOX 809 MILFORD, DE 19963
TEL 302.424.1441 FAX 302.424.0430
WEB www.dbfinc.com

Review: Commissioner's Room 3D

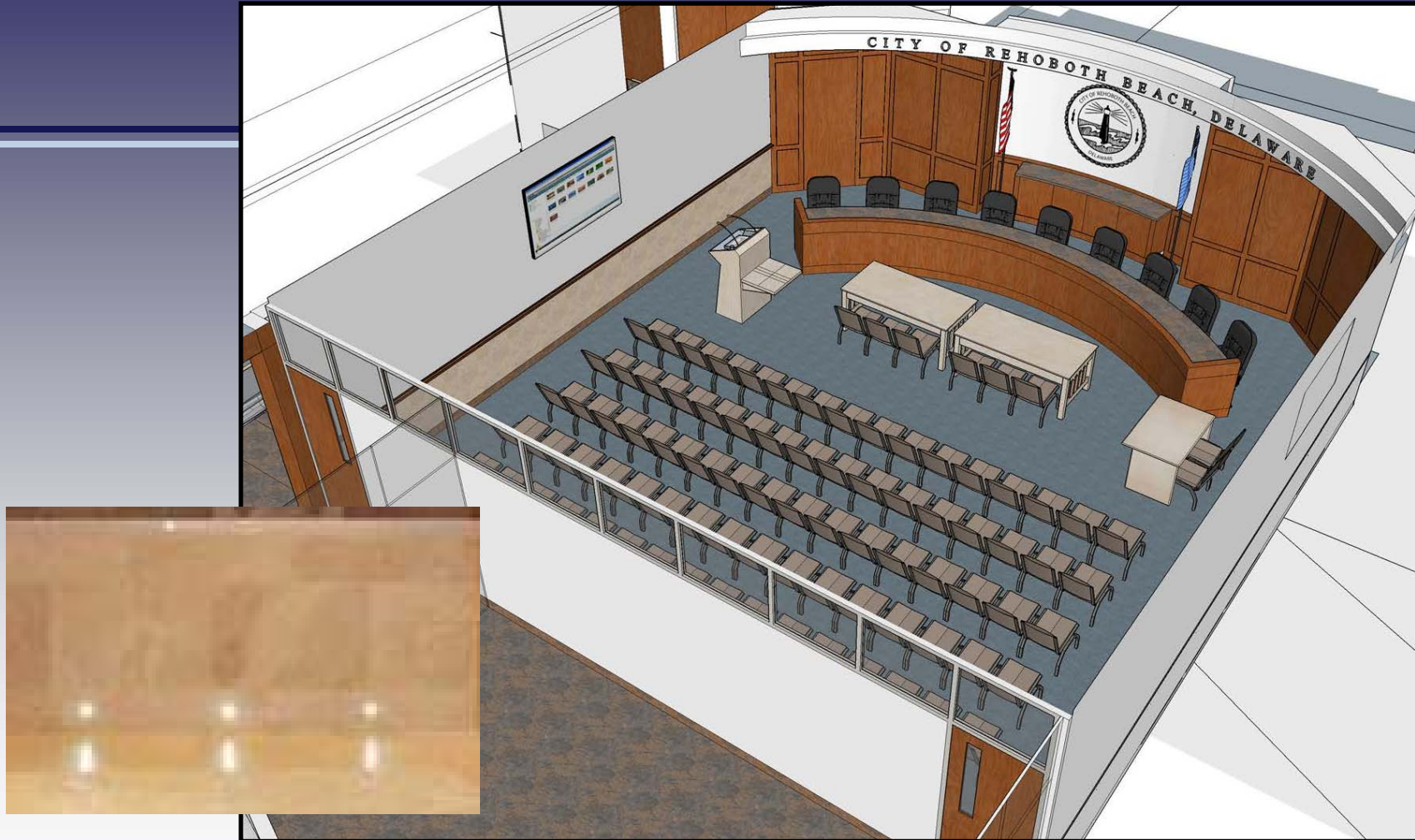

Option 2: Terrazzo/Tile Wainscot



ARCHITECTS ENGINEERS SURVEYORS

ONE PLAZA EAST, SUITE 200 PO. BOX 93 SALISBURY, MD 21803-0093
TEL 410.543.9091 FAX 410.543.4172
23 NORTH WALNUT STREET PO. BOX 809 MILFORD, DE 19963
TEL 302.424.1441 FAX 302.424.0430
WEB www.dbfinc.com

Review: Commissioner's Room 3D

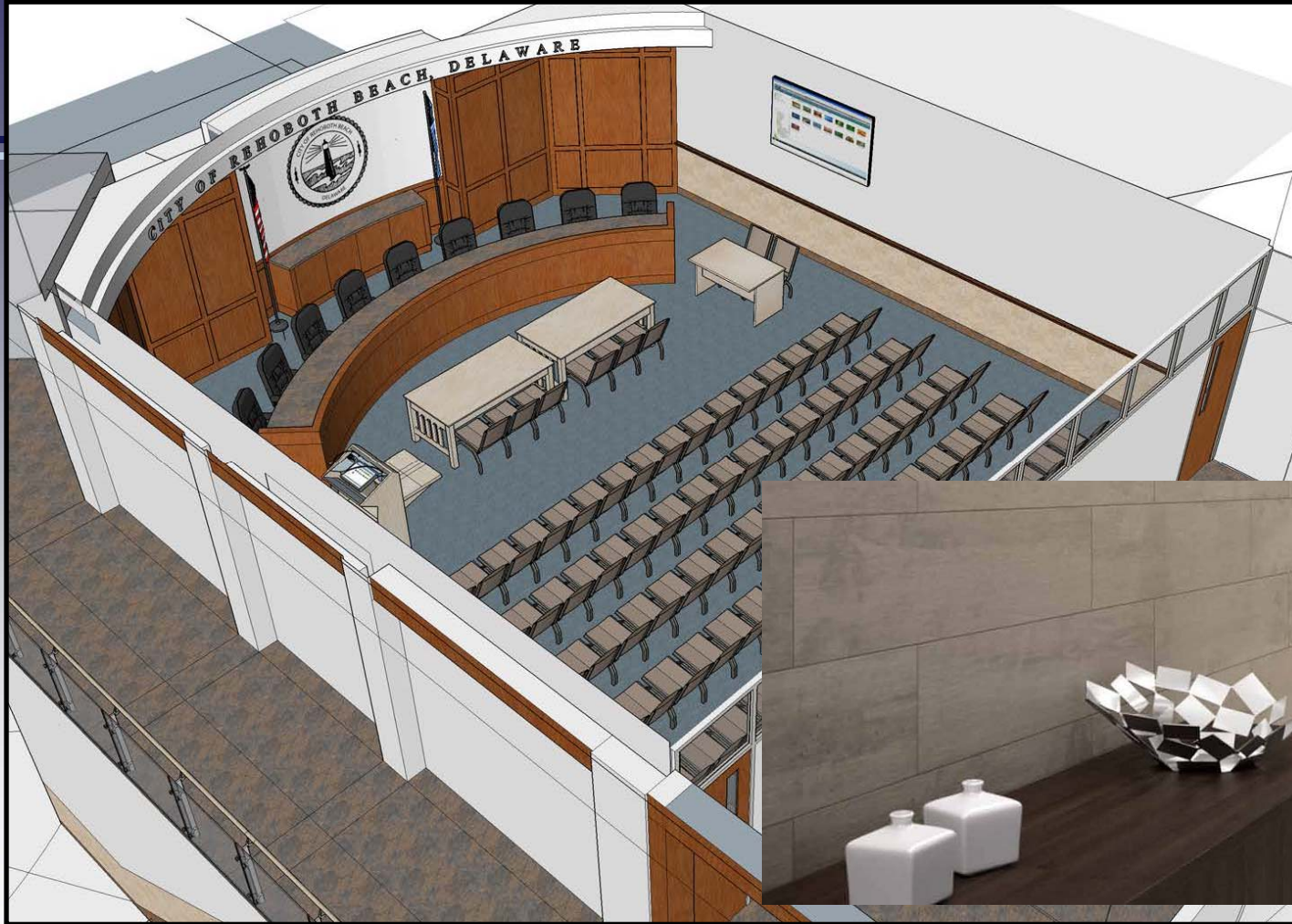

Option 2: Terrazzo/Tile Wainscot



ARCHITECTS ENGINEERS SURVEYORS

ONE PLAZA EAST, SUITE 200 P.O. BOX 93 SALISBURY, MD 21803-0093
TEL 410.543.9091 FAX 410.543.4172
23 NORTH WALNUT STREET P.O. BOX 809 MILFORD, DE 19963
TEL 302.424.1441 FAX 302.424.0430
WEB www.dbfnc.com

Review: Commissioner's Room 3D

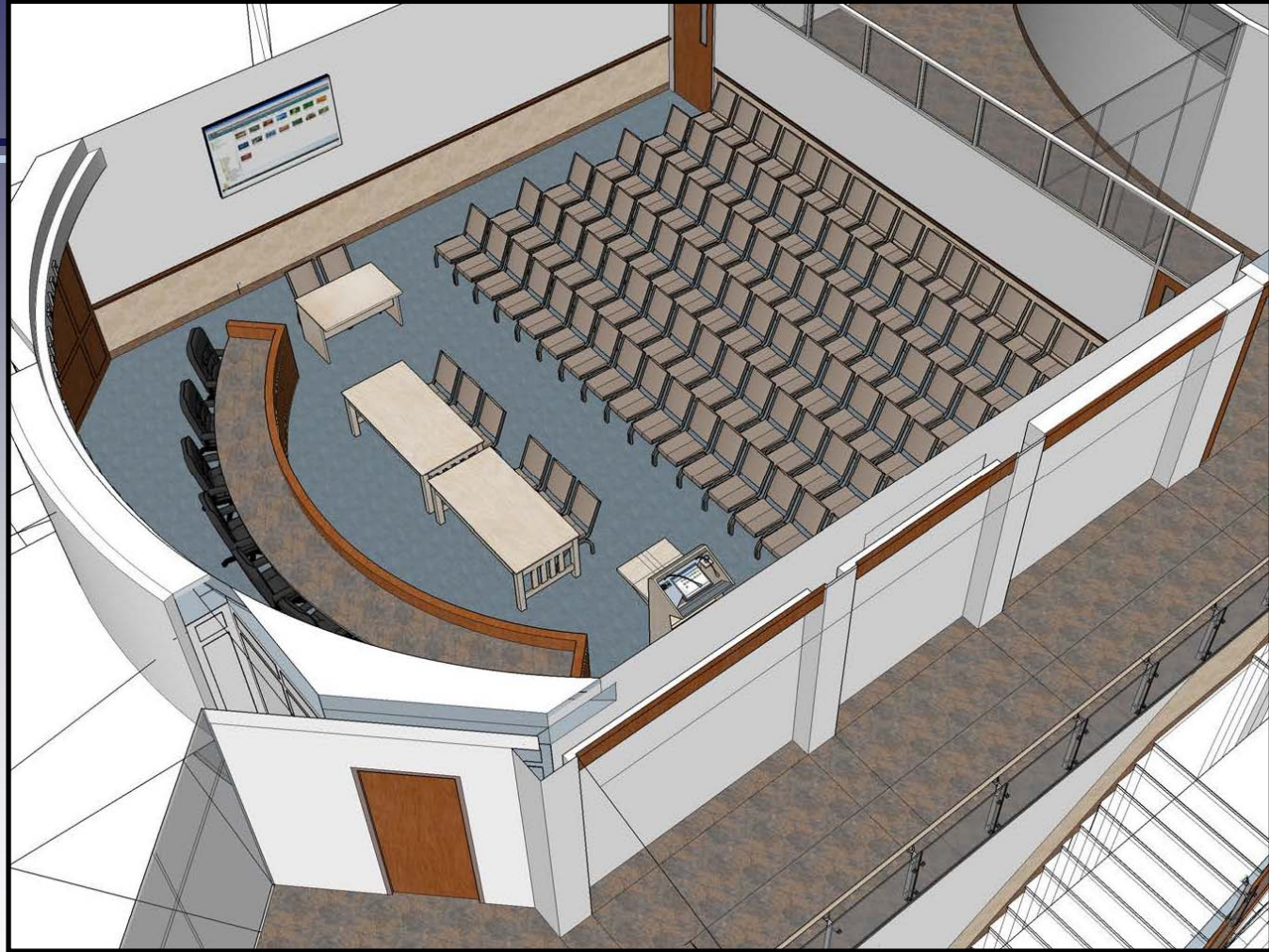

Option 2: Terrazzo/Tile Wainscot



ARCHITECTS ENGINEERS SURVEYORS

ONE PLAZA EAST, SUITE 200 P.O. BOX 93 SALISBURY, MD 21803-0093
TEL 410.543.9091 FAX 410.543.4172
23 NORTH WALNUT STREET P.O. BOX 809 MILFORD, DE 19963
TEL 302.424.1441 FAX 302.424.0430
WEB www.dbfinc.com

Review: Commissioner's Room 3D

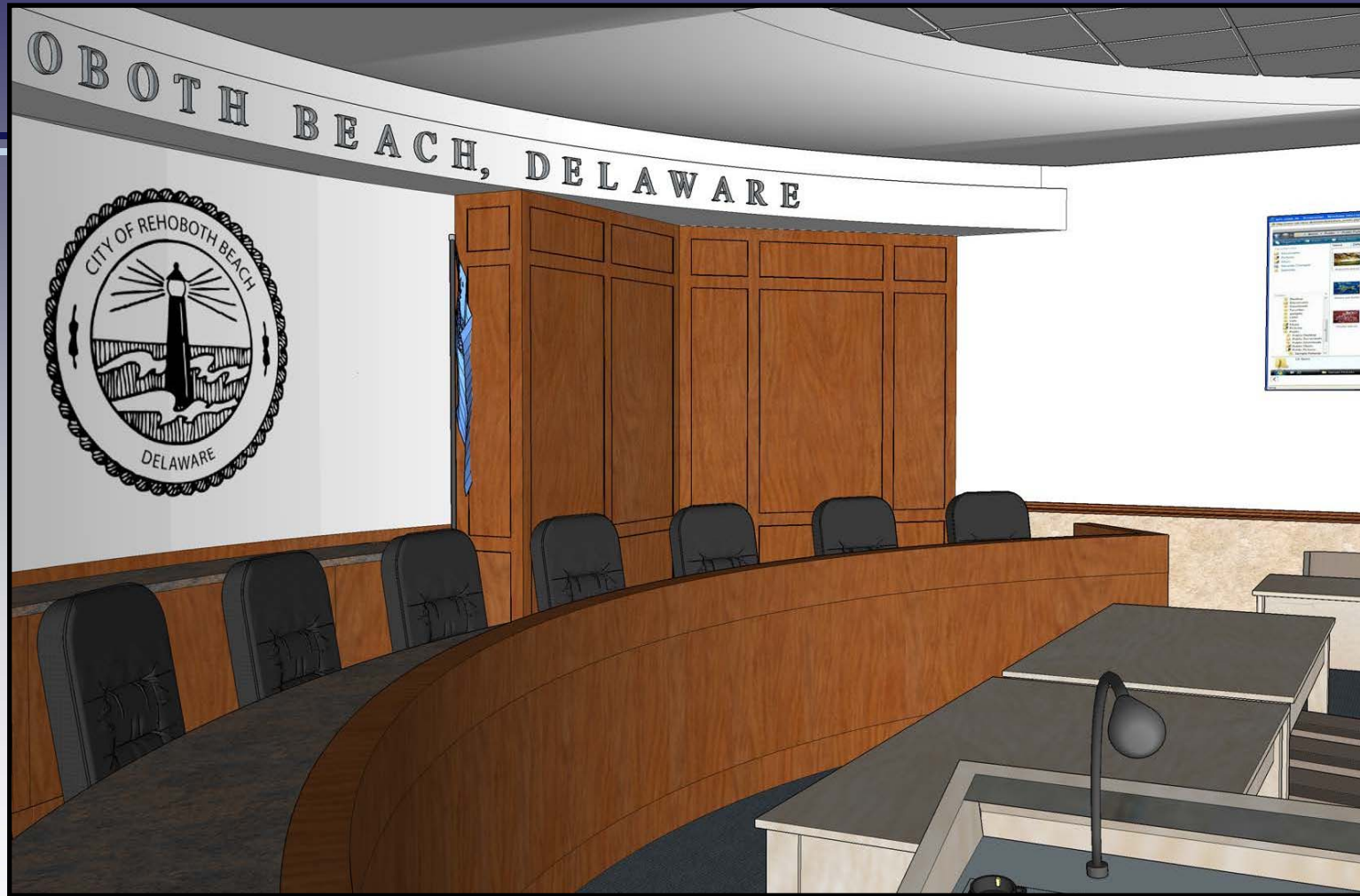

Option 2: Terrazzo/Tile Wainscot



ARCHITECTS ENGINEERS SURVEYORS

ONE PLAZA EAST, SUITE 200 PO. BOX 93 SALISBURY, MD 21803-0093
TEL 410.543.9091 FAX 410.543.4172
23 NORTH WALNUT STREET PO. BOX 809 MILFORD, DE 19963
TEL 302.424.1441 FAX 302.424.0430
WEB www.dbfinc.com

Review: Commissioner's Room 3D



Option 2: Terrazzo/Tile Wainscot



DAVIS
BOWEN &
FRIEDEL, INC.



ARCHITECTS ENGINEERS SURVEYORS

ONE PLAZA EAST, SUITE 200 P.O. BOX 93 SALISBURY, MD 21803-0093
TEL 410.543.9091 FAX 410.543.4172
23 NORTH WALNUT STREET P.O. BOX 809 MILFORD, DE 19963
TEL 302.424.1441 FAX 302.424.0430
WEB www.dbfinc.com

Review: Commissioner's Room 3D

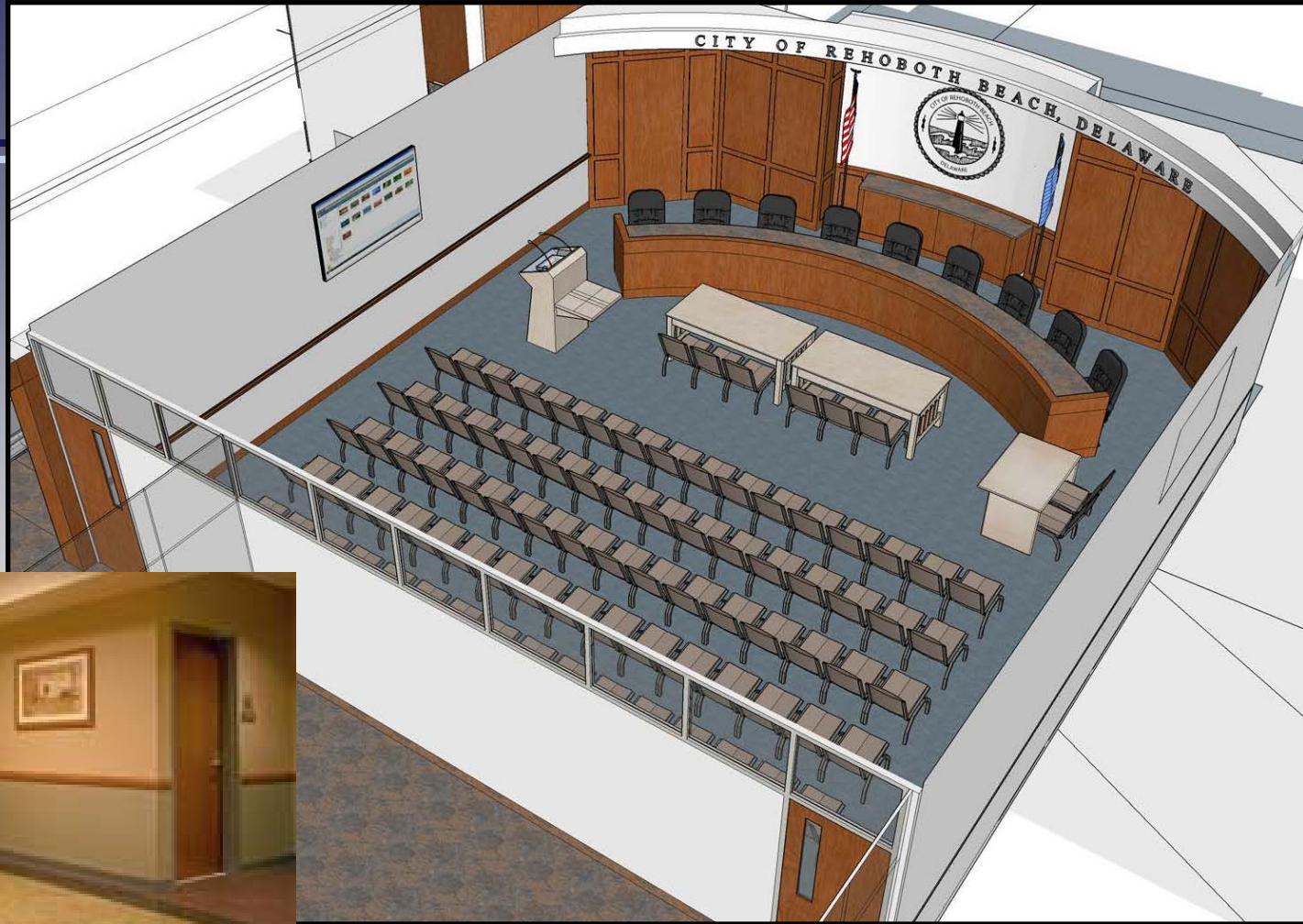

Option 3: No Wainscot



ARCHITECTS ENGINEERS SURVEYORS

ONE PLAZA EAST, SUITE 200 P.O. BOX 93 SALISBURY, MD 21803-0093
TEL 410.543.9091 FAX 410.543.4172
23 NORTH WALNUT STREET P.O. BOX 809 MILFORD, DE 19963
TEL 302.424.1441 FAX 302.424.0430
WEB www.dbfinc.com

Review: Commissioner's Room 3D



Option 3: No Wainscot



ARCHITECTS ENGINEERS SURVEYORS

ONE PLAZA EAST, SUITE 200 PO. BOX 93 SALISBURY, MD 21803-0093
TEL 410.543.9091 FAX 410.543.4172
23 NORTH WALNUT STREET PO. BOX 809 MILFORD, DE 19963
TEL 302.424.1441 FAX 302.424.0430
WEB www.dbfinc.com

Review: Commissioner's Room 3D

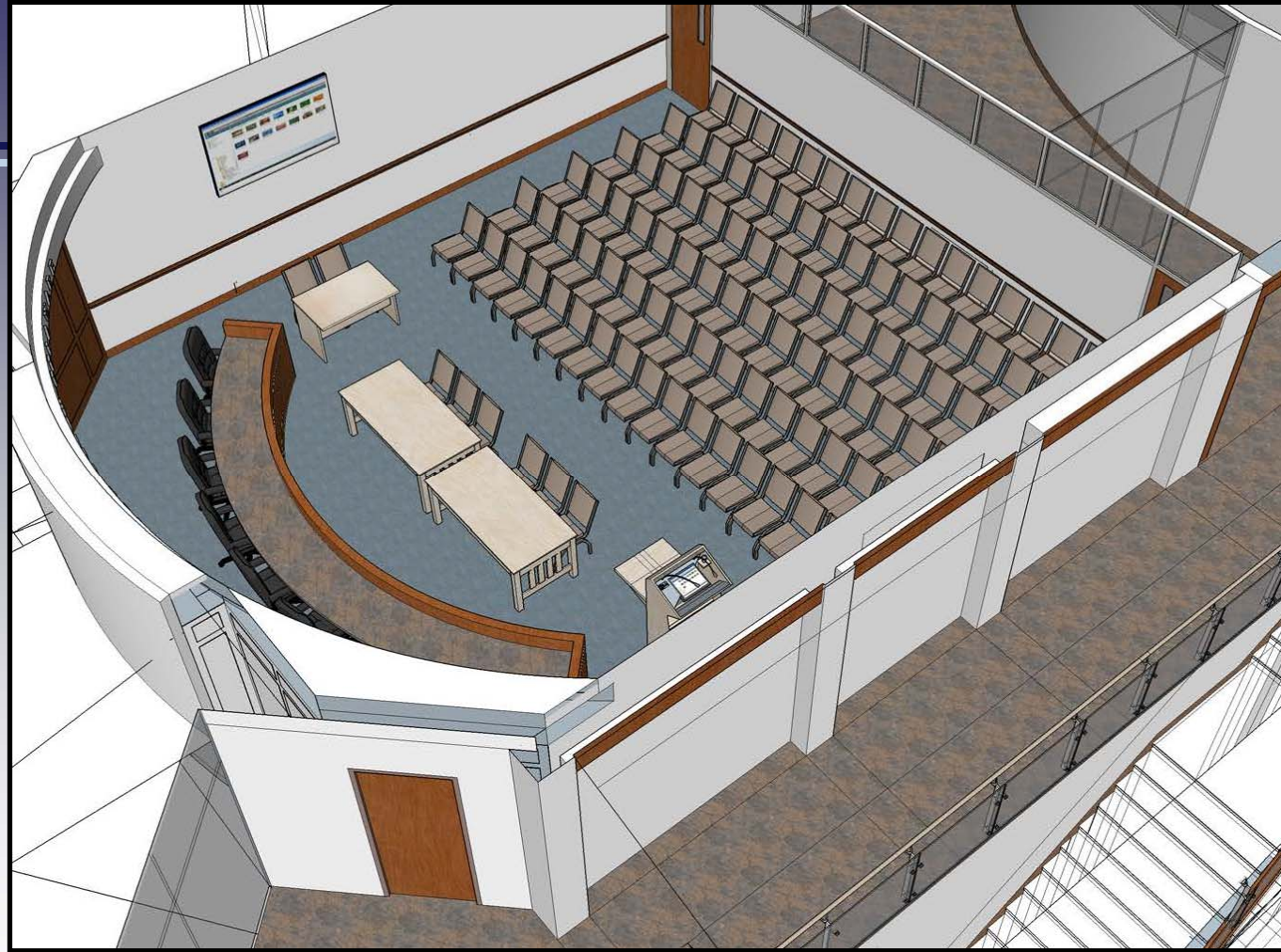

Option 3: No Wainscot



**DAVIS
BOWEN &
FRIEDEL, INC.**



ARCHITECTS ENGINEERS SURVEYORS

ONE PLAZA EAST, SUITE 200 PO. BOX 93 SALISBURY, MD 21803-0093
TEL 410.543.9091 FAX 410.543.4172
23 NORTH WALNUT STREET PO. BOX 809 MILFORD, DE 19963
TEL 302.424.1441 FAX 302.424.0430
WEB www.dbfinc.com

Review: Commissioner's Room 3D

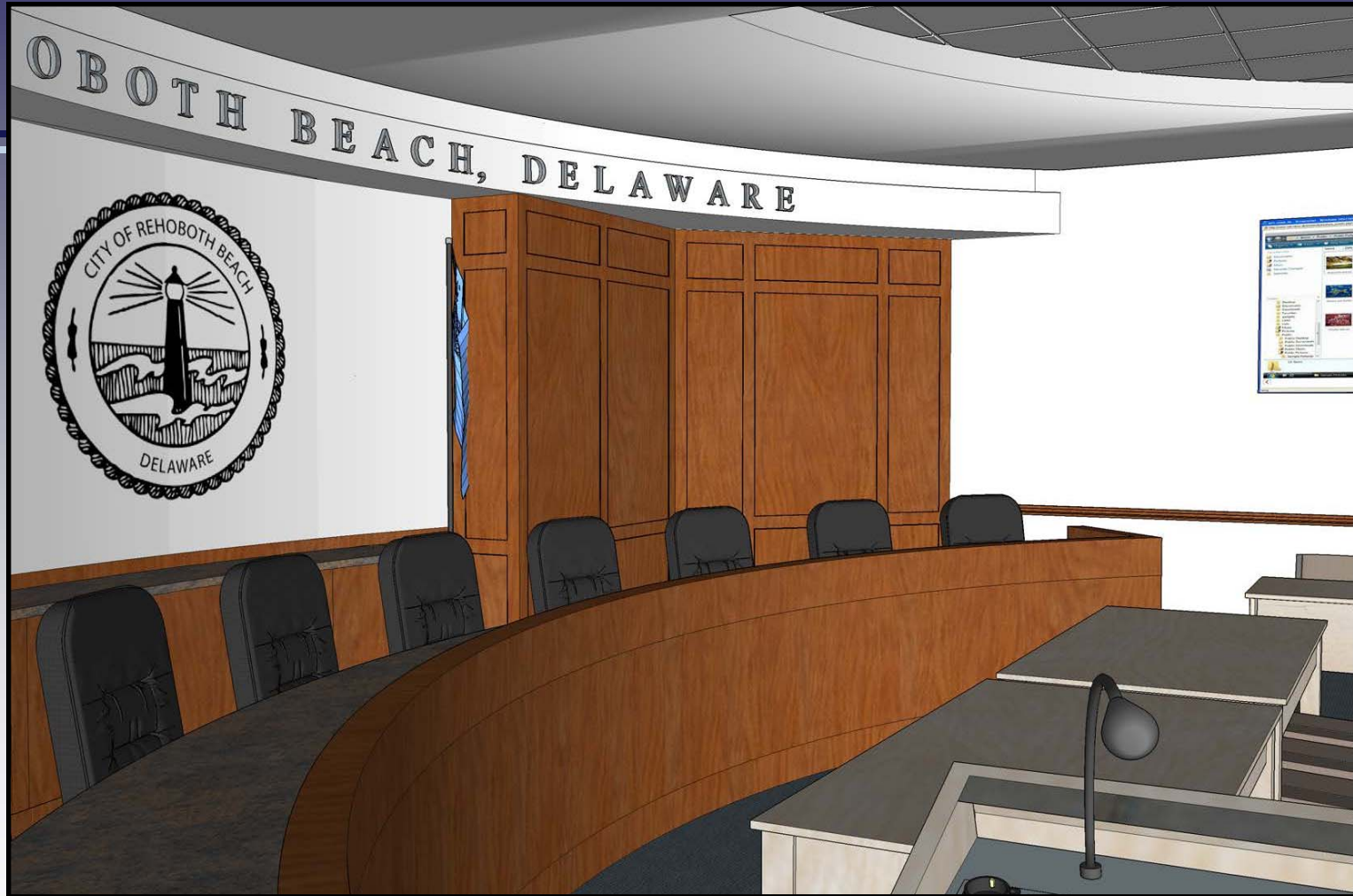

Option 3: No Wainscot



ARCHITECTS ENGINEERS SURVEYORS

ONE PLAZA EAST, SUITE 200 PO. BOX 93 SALISBURY, MD. 21803-0093
TEL 410.543.9091 FAX 410.543.4172
23 NORTH WALNUT STREET PO. BOX 809 MILFORD, DE. 19963
TEL 302.424.1441 FAX 302.424.0430
WEB www.dbfinc.com

Review: Commissioner's Room 3D

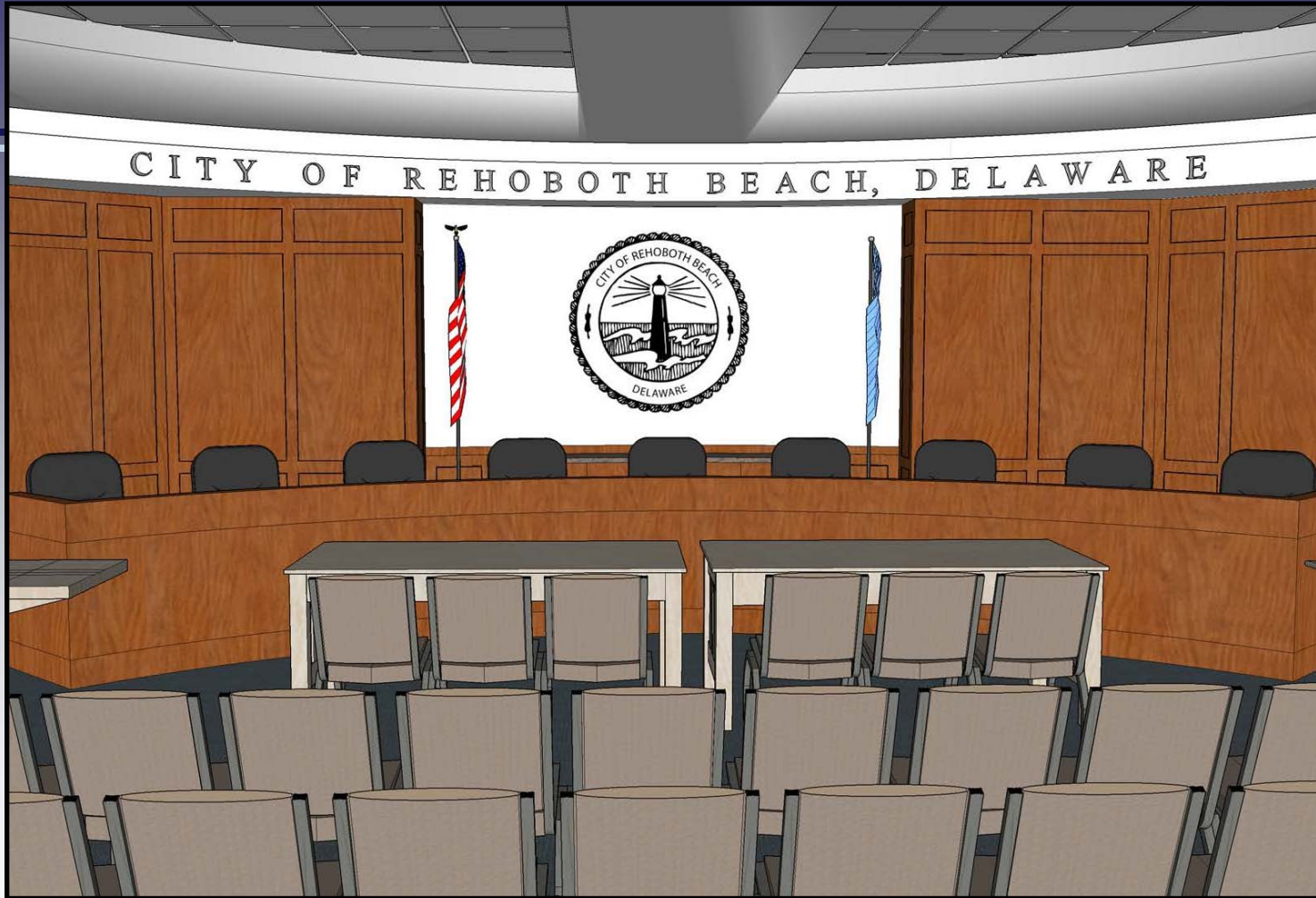

Option 3: No Wainscot



ARCHITECTS ENGINEERS SURVEYORS

ONE PLAZA EAST, SUITE 200 P.O. BOX 93 SALISBURY, MD 21803-0093
TEL 410.543.9091 FAX 410.543.4172
23 NORTH WALNUT STREET P.O. BOX 809 MILFORD, DE 19963
TEL 302.424.1441 FAX 302.424.0430
WEB www.dbfinc.com

Review: Exterior Materials



Brick

Cast Concrete

Fiber Cement Siding

Storefront Window Units

Metal Roof



ARCHITECTS ENGINEERS SURVEYORS

ONE PLAZA EAST, SUITE 200 PO. BOX 93 SALISBURY, MD 21803-0093
TEL 410.543.9091 FAX 410.543.4172
23 NORTH WALNUT STREET PO. BOX 809 MILFORD, DE 19963
TEL 302.424.1441 FAX 302.424.0430
WEB www.dbfinc.com

Review: Exterior Materials



Brick
Cast Concrete
Stucco Siding
Storefront Window Units
Asphalt Roof



DAVIS
BOWEN &
FRIEDEL, INC.



ARCHITECTS ENGINEERS SURVEYORS

ONE PLAZA EAST SUITE 200 PO. BOX 93 SALISBURY, MD 21803-0093
TEL 410.543.9091 FAX 410.543.4172
23 NORTH WALNUT STREET PO. BOX 809 MILFORD, DE 19963
TEL 302.424.1441 FAX 302.424.0430
WEB www.dbfinc.com

Review: Exterior Materials



Brick

Cast Concrete

Fiber Cement Siding

Storefront Window Units

Metal Roof



ARCHITECTS ENGINEERS SURVEYORS

ONE PLAZA EAST, SUITE 200 PO. BOX 93 SALISBURY, MD 21803-0093
TEL 410.543.9091 FAX 410.543.4172
23 NORTH WALNUT STREET PO. BOX 809 MILFORD, DE 19963
TEL 302.424.1441 FAX 302.424.0430
WEB www.dbfinc.com

Rehoboth Beach City Hall Complex: Construction Documents

Review: Updated Costs

BUILDING CONSTRUCTION COST

New Construction

Temporary Modular Offices	\$306,000
Demolition	\$154,665
Sitework	\$1,074,355
New Parking Department Building	\$1,223,551
New City Hall/Police Station	\$10,665,270

Grand Total New Construction \$13,423,841

Construction Fees & Other Construction Costs:

Bidding & Construction Contingency	\$1,241,348
General Conditions (by General Contractor)	\$0
Liability Insurance	\$77,503
Reimbursable Labor - Field	\$257,000
Reimbursable Labor - Other	\$263,995
Owners Representative Pre Construction Fee	\$57,000
Owners Representative Fee	\$481,985
Cost Escalation	\$0

Subtotal Construction Fees & Other Construction Costs \$2,378,831

Grand Total Building Construction Costs \$15,802,672

OTHER CONSTRUCTION RELATED COSTS

Design Services:

Architect/Engineer's Fees	\$990,000
Civil Engineering Fees	\$181,000
Geotechnical Evaluation	\$8,000
FF&E Design fee	\$0

Furniture Fixtures & Equipment:

FF&E Allowance	\$547,318
----------------	-----------

Owners Administrative Costs:

Legal Fees	\$50,000
Builders Risk Insurance	\$25,000
Building Permit Fees	\$0
Testing & Inspections (Estimated)	\$75,000
Fire Marshal Fees	\$55,000
Moving Expenses	\$0
1.5% Owners Contingency	\$266,010

Grand Total Other Construction Related Costs \$2,197,328

GRAND TOTAL PROJECT COSTS **\$18,000,000**

NOTE: All pricing assumes non prevailing wage

ALTERNATE PRICING

1. Re-Skin Existing Convention Center Exterior Wall \$357,434



ARCHITECTS ENGINEERS SURVEYORS

ONE PLAZA EAST SUITE 200 PO. BOX 93 SALESBURY, MD 21803-0093
TEL 410.343.9091 FAX 410.343.4172
23 NORTH WALNUT STREET PO. BOX 809 MILFORD, DE 19963
TEL 302.424.1441 FAX 302.424.0430
WEB www.dbfinc.com

Rehoboth Beach City Hall Complex: Construction Documents

Review: Updated Schedule

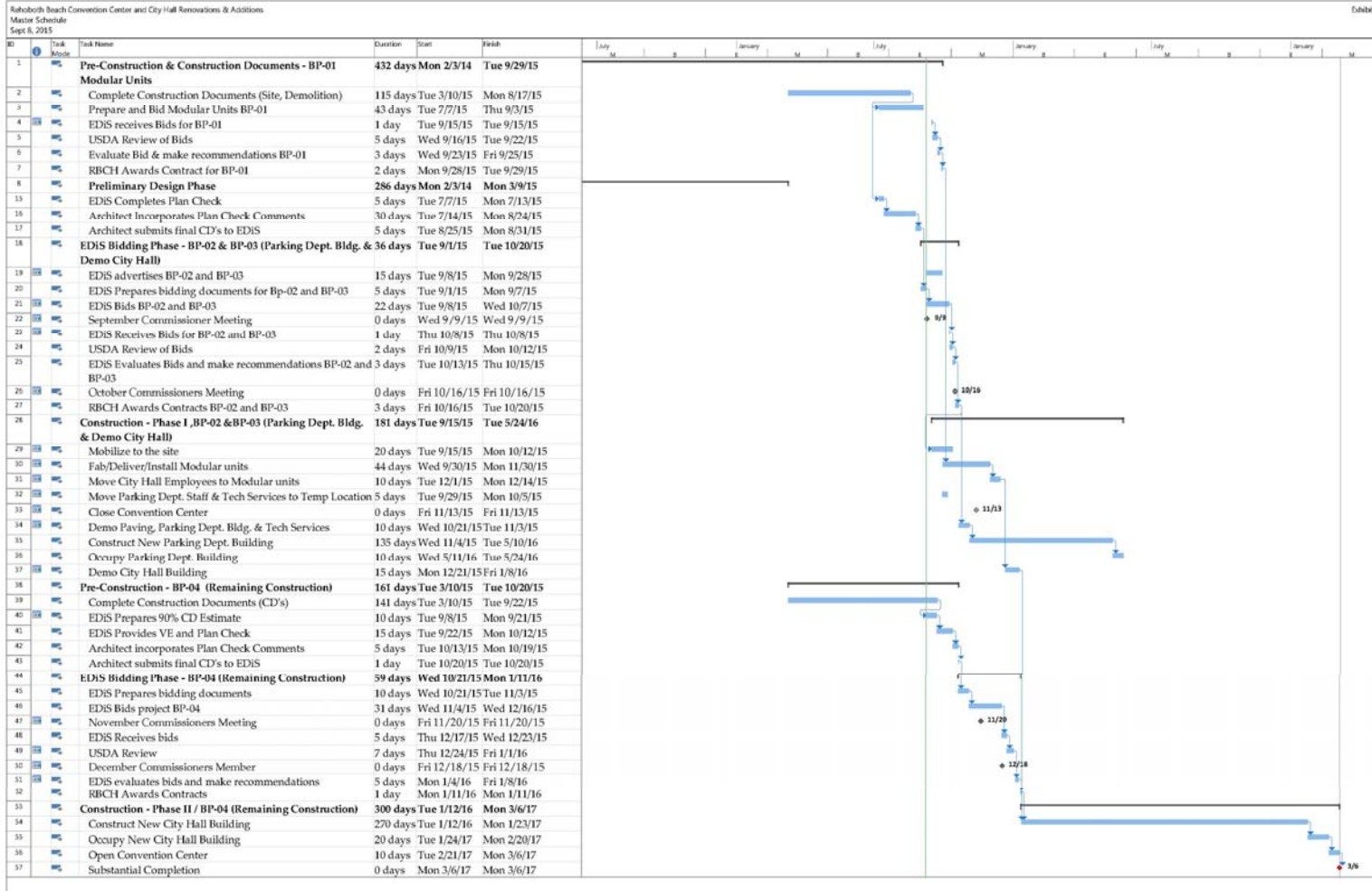

ARCHITECTS ENGINEERS SURVEYORS

ONE PLAZA EAST, SUITE 200 P.O. BOX 93, SALISBURY, MD 21803-0093
TEL 410.543.9091 FAX 410.543.4172
23 NORTH WALNUT STREET P.O. BOX 809, MILFORD, DE 19963
TEL 302.424.1441 FAX 302.424.0430
WEB www.dbfinc.com